

82  
B

LUCAS W. WRIGHT  
BK. 52297-94  
(5/07/14)

5.71 ACRES

LUCAS W. & KIMBERLY H.  
WRIGHT

BK. 20432-262 (9/18/98)

37.4<sup>±</sup> ACRES

(SEE PL. BK. 339 PL. 74)

PLAINS ROAD  
1098.40'  
2136.14'

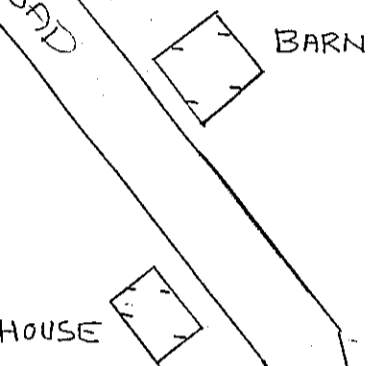

1

THE WRIGHT FAMILY IRREVOCABLE TRUST

BK. 40334-95 (12/13/06)

78.339 ACRES

COMMONWEALTH OF MASSACHUSETTS

BK. 2718-1 (3/24/38)

1747.07'

1032.75'

84  
A

754.08'

679.23'

102.86' 246.48' 104.52' 130.82'

LARSON FAMILY REVOCABLE TRUST  
BK. 56504-343 (12/21/16)

8.385 ACRES

679.08'

182.13'

84  
B

86  
B

333.32' 133.01' 85.23'