

SECRETARY OF HOUSING AND URBAN DEVELOPMENT  
BK. 60684-202 (7/11/19)  
2.4 ACRES

ANDREW D. WARD  
BK. 48054-282 (11/6/11)  
1.28 ACRES

LYLE A. & JOYCE A. PLANTE  
BK. 20980-372 (1/29/99)  
5.03 ACRES

ERIC A. & COURTNEY L. SANDERSON  
BK. 43088-91  
2.37 ACRES

ROBERT D. & REGINA M. SANDERSON  
BK. 43605-327  
BK. 35012-51  
BK. 32720-325  
BK. 13332-181  
3.54 ACRES

RYAN D. & JADRIENNE SANDERSON  
BK. 48886-19 (4/27/12)  
BK. 38585-1 (12/1/05)  
2.385 ACRES

EDWARD W. & HEATHER L. PACEK  
BK. 47838-1 (9/16/11)  
16.21 ACRES  
(SEE PL. BK. 875 PL. 74)

ROMAN CATHOLIC BISHOP OF WORCESTER  
BK. 37815-272 (11/16/2005)  
BK. 3892-135 (9/14/57)  
15.8 ACRES

JOHN J. & AMANDA L. MAILHOT  
BK. 55592-89 (7/5/16)  
1.48 ACRES

EDWARD W. & HEATHER L. PACEK  
BK. 47838-1 (9/16/11)  
2.616 ACRES

SALVATORE D. & JOAN E. MORELLI  
BK. 44290-294 (5/22/2009)  
- 1ST & 2ND TRACTS -  
35.783 ACRES  
(SEE PL. BK. 769 PL. 44)  
( " PL. BK. 834 PL. 71)

KEVIN D. MENTZER  
BK. 57816-108 (12/31/18)  
1.836 ACRES

DUNROAMIN COUNTRY CLUB, INC.  
BK. 26979-384 (6/14/02)  
12.508 ACRES  
(SEE PL. BK. 782 PL. 100)

DEAN MARCUS  
BK. 12170-236 (6/21/87)  
29.188 ACRES

TOWN OF HARDWICK  
BK. 10693-54 (8/5/87)  
38.14 ACRES

CAITLIN J. SANDERSON  
BK. 55899-172 (8/31/16)  
1.972 ACRES

PATRICK M. ROACH  
BK. 10837-252  
1.824 ACRES

ANTHONY M. & MYA L. HAY  
BK. 24183-7 (6/8/01)  
12.28 ACRES

MASSACHUSETTS CENTRAL RAILROAD CORPORATION  
BK. 18636-262  
(7,200 ± SQ. FT.)

JOANNE MORRISON  
BK. 26608-122 (11/2/98)  
1.227 ACRES

TOWN OF HARDWICK  
BK. 55163-205 (4/8/16)  
2.439 ACRES

TOWN OF HARDWICK  
BK. 50496-114 (2/15/13)  
6.8 ACRES

MARK W. & LORENE D. FILGERLESKI  
BK. 10464-46 (5/18/87)  
1.956 ACRES

DAHA F. LLOYD & LINDA S. THOMPSON  
BK. 10517-187 (6/3/87)  
553.38 ACRES

DAVID MILLER  
BK. 52985  
R. 295  
600 ±

RIVER

WARE

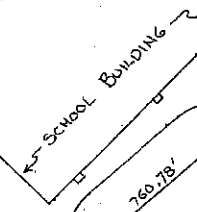

CENTRAL ROAD

RAIL ROAD

WARE

CHURCH STREET

DRIVE

ROAD

WARE

CENTRAL ROAD

WARE

WARE

CHURCH STREET

DRIVE

ROAD

WARE

CENTRAL ROAD

WARE

WARE