

WARE

RIVER

PIONEER TERMINALS, INC.  
BK. 3421-169 (5/29/52)  
8.28 ± ACRES

GILBERTVILLE STORAGE, INC.  
BK. 3395-256 (1/28/52)

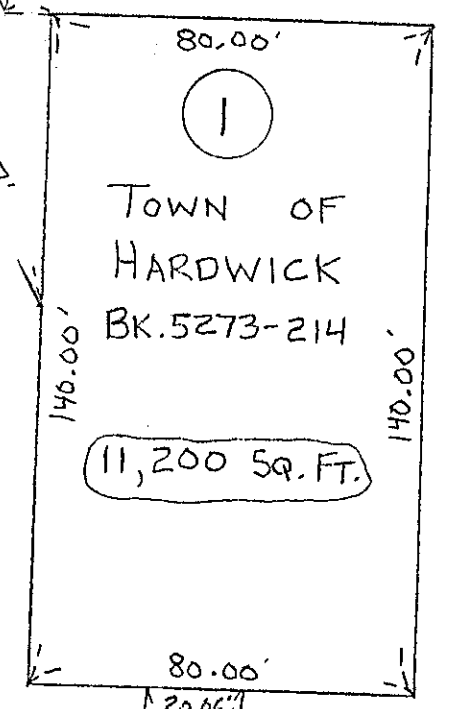

GILBERTVILLE STORAGE, INC.  
BK. 3395-256 (1/28/52)  
4.22 ACRES

TOWN OF HARDWICK (EASEMENT)  
BK. 5273-214 (12/17/72)

MASSACHUSETTS CENTRAL RAILROAD CORPORATION